

# Top Roller Chains

Top Roller chain is based on ANSI roller chain with extra roller mounted on top of the chain. Top rollers are installed on the pins that connect SK-1 extended plates. The Rollers may be carbon steel, stainless steel, or low friction plastic.

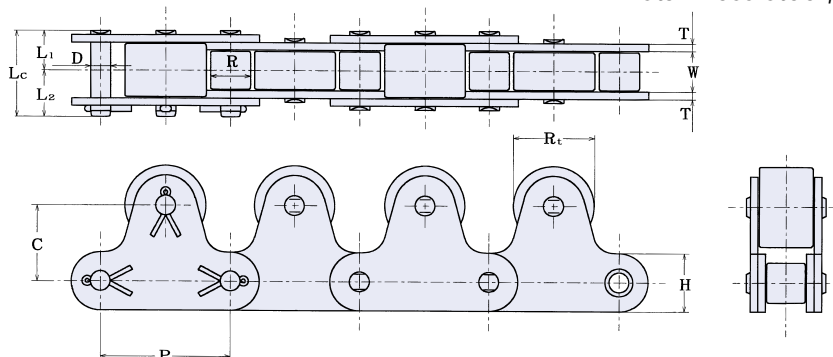

Top Roller Dia. Only E every Link

SY-40	11.00
SY-50	15.00
SY-60	18.00
SY-80	24.00
SY-100	30.00

SY Chain No.	Dimensions - mm										Average Ultimate Strength kN	Average Chain Weight kg/m
	Pitch P	Roller		Pin			Plate		Top-Roller			
		Width W	Dia. R	Dia. D	Length L1 L2		Height H	Thickness T	Position C	Dia. Rt		
SY-40	12.70	7.95	7.92	3.96	8.2	9.1	11.7	1.5	12.7	15.88	19.1	1.10
SY-50	15.875	9.53	10.16	5.08	10.3	11.6	14.6	2.0	15.9	19.05	31.9	1.61
SY-60	19.05	12.70	11.91	5.95	12.7	13.9	17.5	2.4	18.3	22.23	43.1	2.80
SY-80	25.40	15.88	15.88	7.93	16.2	18.8	23.4	3.2	24.6	28.58	78.5	4.60
SY-100	31.75	19.05	19.05	9.53	19.6	23.2	29.3	4.0	31.8	39.67	118	7.60
C2040	25.40	7.95	7.92	3.96	8.2	10.3	11.4	1.5	15.0	15.88	19.1	1.29
C2050	31.75	9.53	10.16	5.08	10.3	11.6	15.0	2.0	19.0	19.05	31.9	1.99
C2060H	38.10	12.70	11.91	5.95	14.4	16.7	17.0	3.2	23.0	22.23	54.9	3.50
C2080H	50.80	15.88	15.88	7.93	17.8	21.1	22.6	4.0	29.0	28.58	90.2	5.30
C2100H	63.50	19.05	19.05	9.53	21.1	24.6	28.6	4.8	35.4	39.67	137	8.60
C2042	25.40	7.95	15.88	3.96	8.2	10.3	11.4	1.5	15.0	15.88	19.1	1.61
C2052	31.75	9.53	19.05	5.08	10.3	11.6	15.0	2.0	19.0	19.05	31.9	2.50
C2062H	38.10	12.70	22.23	5.95	14.4	16.7	17.0	3.2	23.0	22.23	54.9	4.30
C2082H	50.80	15.88	28.58	7.93	17.8	21.1	22.6	4.0	29.0	28.58	90.2	6.50
C2102H	63.50	19.05	39.67	9.53	21.1	24.6	28.6	4.8	35.4	39.67	137	10.70

Average weight shows chains with top rollers spaced every second.  
For chains with oversized carrier rollers, special sprocket is used.